

BF

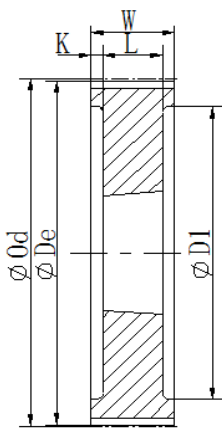

C

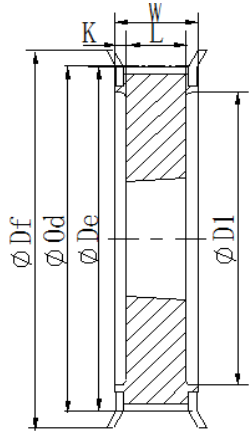

CF

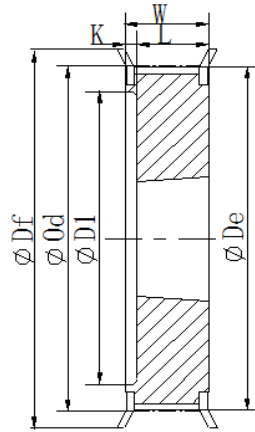

DF

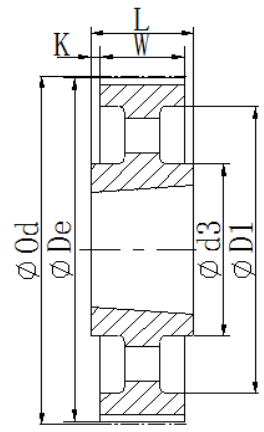

GA

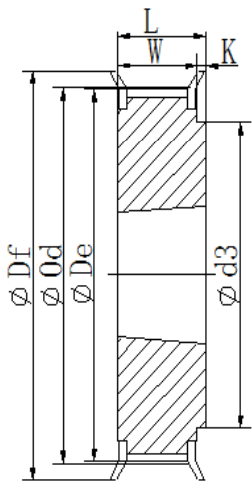

HF

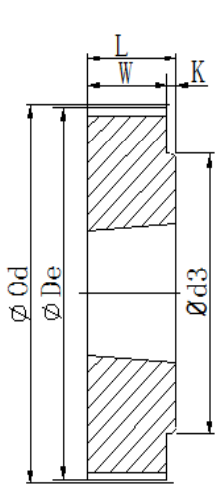

H

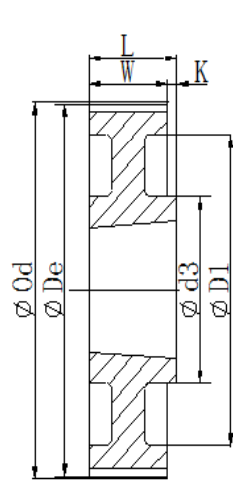

HA

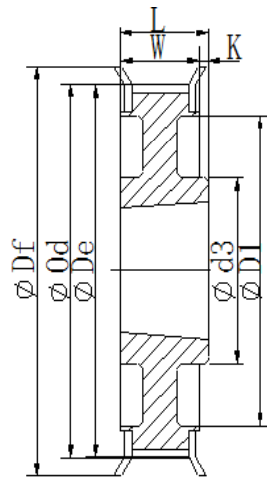

HCF

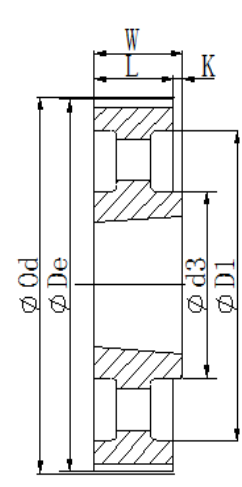

HC

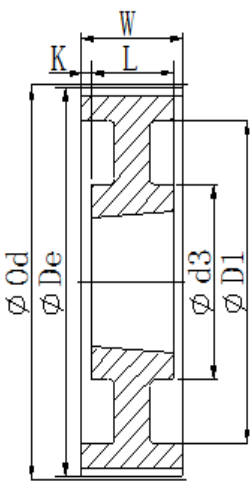

IC

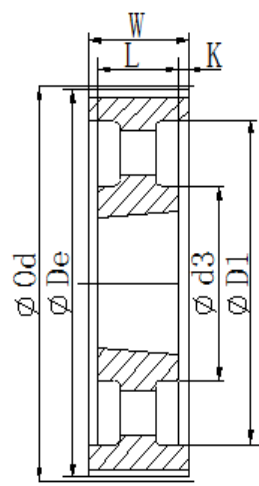

IA

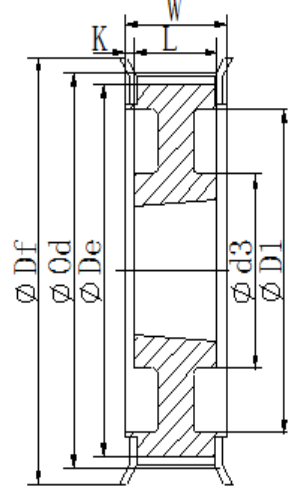

ICF



**HTD 5M-15**

CCGMF CODE 规格	Z 齿数	Type 结构	MAT. 材料	BUSH NO. 锥孔号	Od	De	Df	d3	D1	W	L	K
TL34-5M-15	34	BF	STEEL	1008	54.11	52.97	57	-	-	22	22	-
TL36-5M-15	36	BF	STEEL	1108	57.30	56.15	60	-	-	22	22	-
TL38-5M-15	38	BF	STEEL	1108	60.48	59.34	66	-	-	22	22	-
TL40-5M-15	40	BF	STEEL	1108	63.66	62.52	70	-	-	22	22	-
TL44-5M-15	44	BF	STEEL	1108	70.03	68.89	75	-	-	22	22	-
TL48-5M-15	48	HF	STEEL	1210	76.39	75.25	83	59	-	22	25	3
TL56-5M-15	56	HF	STEEL	1210	89.13	87.39	93	70	-	22	25	3
TL64-5M-15	64	HF	STEEL	1210	101.86	100.72	106	80	-	22	25	3
TL72-5M-15	72	H	STEEL	1610	114.59	113.45	-	92	-	22	25	3
TL80-5M-15	80	H	STEEL	1610	127.32	126.18	-	92	-	22	25	3
TL90-5M-15	90	H	STEEL	1610	143.24	142.1	-	92	-	22	25	3
TL112-5M-15	112	H	STEEL	2012	178.25	177.11	-	110	-	20	32	12
TL136-5M-15	136	GA	STEEL	2012	216.45	215.31	-	110	199	20	32	6

**HTD 8M-20**

CCGMF CODE 规格	Z 齿数	Type 结构	MAT. 材料	BUSH NO. 锥孔号	Od	De	Df	d3	D1	W	L	K
TL22-8M-20	22	DF	STEEL	1108	56.02	56.45	60	-	37	28	22	6
TL24-8M-20	24	DF	STEEL	1108	61.12	59.75	66	-	44	28	22	6
TL26-8M-20	26	DF	STEEL	1108	66.21	64.84	70	-	45	28	22	6
TL28-8M-20	28	DF	STEEL	1108	71.30	70.08	75	-	50	28	22	6
TL30-8M-20	30	DF	STEEL	1108	76.39	75.13	83	-	58	28	22	6
TL32-8M-20	32	DF	STEEL	1610	81.49	80.16	87	-	63	28	25	3
TL34-8M-20	34	DF	STEEL	1610	86.58	85.22	91	-	64	28	25	3
TL36-8M-20	36	DF	STEEL	1610	91.67	90.30	97	-	68	28	25	3
TL38-8M-20	38	DF	STEEL	1610	96.77	95.39	102	-	72	28	25	3
TL40-8M-20	40	DF	STEEL	1610	101.86	100.49	106	-	76	28	25	3
TL44-8M-20	44	HF	STEEL	2012	112.05	110.67	120	93	-	28	32	4
TL48-8M-20	48	HF	STEEL	2012	122.23	120.86	128	96	-	28	32	4
TL56-8M-20	56	HF	STEEL	2012	142.60	141.23	150	110	-	28	32	4
TL64-8M-20	64	HCF	STEEL	2012	162.97	161.60	168	110	137	28	32	4
TL72-8M-20	72	HCF	STEEL	2012	183.35	181.97	192	110	158	28	32	4
TL80-8M-20	80	HC	CAST IRON	2012	203.72	202.35	-	110	180	28	32	4
TL90-8M-20	90	HA	CAST IRON	2012	229.18	227.81	-	110	204	28	32	4
TL144-8M-20	144	HA	CAST IRON	2517	366.69	365.32	-	125	336	28	32	4

**HTD 8M-30**

CCGMF CODE 规格	Z 齿数	Type 结构	MAT. 材料	BUSH NO. 锥孔号	Od	De	Df	d3	D1	W	L	K
TL22-8M-30	22	DF	STEEL	1108	56.02	56.45	60	-	37	38	22	16
TL24-8M-30	24	DF	STEEL	1108	61.12	59.75	66	-	44	38	22	16
TL26-8M-30	26	DF	STEEL	1108	66.21	64.84	70	-	44	38	22	16
TL28-8M-30	28	DF	STEEL	1210	71.30	70.08	75	-	50	38	25	13
TL30-8M-30	30	BF	STEEL	1615	76.39	75.13	83	-	-	38	38	-
TL32-8M-30	32	BF	STEEL	1615	81.49	80.16	87	-	-	38	38	-
TL34-8M-30	34	BF	STEEL	1615	86.58	85.22	91	-	-	38	38	-
TL36-8M-30	36	BF	STEEL	1615	91.67	90.30	97	-	-	38	38	-
TL38-8M-30	38	BF	STEEL	1615	96.77	95.39	102	-	-	38	38	-
TL40-8M-30	40	BF	STEEL	1615	101.86	100.49	106	-	-	38	32	3
TL44-8M-30	44	CF	STEEL	2012	112.05	110.67	120	-	86	38	32	3
TL48-8M-30	48	CF	STEEL	2012	122.23	120.86	128	-	90	38	32	3
TL56-8M-30	56	CF	STEEL	2012	142.60	141.23	150	-	110	38	45	7
TL64-8M-30	64	HF	STEEL	2517	162.97	161.60	168	125	-	38	45	7
TL72-8M-30	72	HCF	STEEL	2517	183.35	181.97	192	125	158	38	45	7
TL80-8M-30	80	HC	CAST IRON	2517	203.72	202.35	-	125	180	38	45	7
TL90-8M-30	90	HA	CAST IRON	2517	229.18	227.81	-	125	204	38	45	7
TL112-8M-30	112	HA	CAST IRON	2517	285.21	183.83	-	125	254	38	45	7
TL144-8M-30	144	HA	CAST IRON	2517	366.69	365.32	-	125	336	38	45	7



**HTD 8M-50**

CCGMF CODE 规格	Z 齿数	Type 结构	MAT. 材料	BUSH NO. 锥孔号	Od	De	Df	d3	D1	W	L	K
TL28-8M-50	28	CF	STEEL	1210	71.30	70.08	75	-	50	60	25	17.5
TL30-8M-50	30	DF	STEEL	1615	76.39	75.13	83	-	58	60	38	22
TL32-8M-50	32	DF	STEEL	1615	81.49	80.16	87	-	62	60	38	22
TL34-8M-50	34	DF	STEEL	1615	86.58	85.22	91	-	65	60	38	22
TL36-8M-50	36	DF	STEEL	1615	91.67	90.30	97	-	68	60	38	22
TL38-8M-50	38	DF	STEEL	1615	96.77	95.39	102	-	72	60	38	22
TL40-8M-50	40	CF	STEEL	2012	101.86	100.49	106	-	82	60	32	14
TL44-8M-50	44	CF	STEEL	2012	112.05	110.67	120	-	91	60	32	14
TL48-8M-50	48	CF	STEEL	2012	122.23	120.86	128	-	95	60	32	14
TL56-8M-50	56	CF	STEEL	2517	142.60	141.23	150	-	116	60	45	7.5
TL64-8M-50	64	CF	STEEL	2517	162.97	161.60	168	-	137	60	45	7.5
TL72-8M-50	72	ICF	STEEL	2517	183.35	181.97	192	125	158	60	45	7.5
TL80-8M-50	80	C	CAST IRON	3020	203.72	202.35	-	-	180	60	51	4.5
TL90-8M-50	90	IC	CAST IRON	3020	229.18	227.81	-	170	204	60	51	4.5
TL112-8M-50	112	IC	CAST IRON	3020	285.21	283.83	-	170	260	60	51	4.5
TL144-8M-50	144	IA	CAST IRON	3020	366.69	365.32	-	170	341	60	51	4.5
TL168-8M-50	168	GA	CAST IRON	3020	427.81	426.44	-	198	402	60	65	2.5
TL144-8M-50	144	GA	CAST IRON	3020	366.69	365.32	-	198	460	60	65	2.5

**HTD 8M-85**

CCGMF CODE 规格	Z 齿数	Type 结构	MAT. 材料	BUSH NO. 锥孔号	Od	De	Df	d3	D1	W	L	K
TL34-8M-85	34	CF	STEEL	1615	86.58	85.22	91	-	65	95	38	28.5
TL36-8M-85	36	CF	STEEL	1615	91.67	90.30	97	-	68	95	38	28.5
TL38-8M-85	38	CF	STEEL	1615	96.77	95.39	102	-	72	95	38	28.5
TL40-8M-85	40	CF	STEEL	2012	101.86	100.49	106	-	82	95	32	31.5
TL44-8M-85	44	CF	STEEL	2012	112.05	110.67	120	-	91	95	32	31.5
TL48-8M-85	48	CF	STEEL	2517	122.23	120.86	128	-	100	95	45	25
TL56-8M-85	56	CF	STEEL	2517	142.60	141.23	150	-	117	95	45	25
TL64-8M-85	64	CF	STEEL	2517	162.97	161.60	168	-	137	95	45	25
TL72-8M-85	72	CF	STEEL	3020	183.35	181.97	192	-	158	95	51	22
TL80-8M-85	80	C	CAST IRON	3020	203.72	202.35	-	-	180	95	51	22
TL90-8M-85	90	IC	CAST IRON	3020	229.18	227.81	-	170	204	95	51	22
TL112-8M-85	112	IC	CAST IRON	3020	285.21	283.83	-	170	260	95	51	22
TL144-8M-85	144	IA	CAST IRON	3525	366.69	365.32	-	198	336	95	65	15
TL168-8M-85	168	IA	CAST IRON	3525	427.81	426.44	-	198	395	95	65	15
TL192-8M-85	192	IA	CAST IRON	3525	488.92	487.55	-	198	455	95	65	15

**HTD 14M-40**

CCGMF CODE 规格	Z 齿数	Type 结构	MAT. 材料	BUSH NO. 锥孔号	Od	De	Df	d3	D1	W	L	K
TL28-14M-40	28	CF	STEEL	2012	124.78	122.12	128	-	94	54	32	11
TL29-14M-40	29	CF	STEEL	2012	129.23	126.57	138	-	98	54	32	11
TL30-14M-40	30	CF	STEEL	2012	133.69	130.99	138	-	98	54	32	11
TL32-14M-40	32	CF	STEEL	2012	142.60	139.88	154	-	108	54	32	11
TL34-14M-40	34	CF	STEEL	2517	151.52	148.79	160	-	110	54	45	4.5
TL36-14M-40	36	CF	STEEL	2517	160.43	157.68	168	-	120	54	45	4.5
TL38-14M-40	38	CF	STEEL	2517	169.34	166.60	184	-	130	54	45	4.5
TL40-14M-40	40	CF	STEEL	2517	178.25	175.49	188	-	138	54	45	4.5
TL44-14M-40	44	CF	STEEL	3020	196.08	193.28	212	-	155	54	51	1.5
TL48-14M-40	48	CF	STEEL	3020	213.90	211.11	226	-	170	54	51	1.5
TL56-14M-40	56	ICF	STEEL	3020	249.55	246.76	256	170	208	54	51	1.5
TL64-14M-40	64	ICF	CAST IRON	3020	285.21	282.41	296	170	240	54	51	1.5
TL72-14M-40	72	IC	CAST IRON	3020	320.86	318.06	-	170	280	54	51	1.5



**HTD 14M-40**

CCGMF CODE 规格	Z 齿数	Type 结构	MAT. 材料	BUSH NO. 锥孔号	Od	De	Df	d3	D1	W	L	K
TL80-14M-40	80	IA	CAST IRON	3020	356.51	353.71	-	170	315	54	51	1.5
TL90-14M-40	90	IA	CAST IRON	3020	401.07	398.28	-	170	360	54	51	1.5
TL112-14M-40	112	IA	CAST IRON	3020	499.11	496.32	-	170	457	54	51	1.5
TL144-14M-40	144	IA	CAST IRON	3020	641.71	638.92	-	170	600	54	51	1.5
TL168-14M-40	168	IA	CAST IRON	3020	748.66	745.87	-	170	706	54	51	1.5
TL192-14M-40	192	IA	CAST IRON	3020	855.62	852.82	-	170	813	54	51	1.5
TL216-14M-40	216	IA	CAST IRON	3020	962.57	959.76	-	170	920	54	51	1.5

**HTD 14M-55**

CCGMF CODE 规格	Z 齿数	Type 结构	MAT. 材料	BUSH NO. 锥孔号	Od	De	Df	d3	D1	W	L	K
TL28-14M-55	28	CF	STEEL	2012	124.78	122.12	128	-	94	70	32	19
TL29-14M-55	29	CF	STEEL	2012	129.23	126.57	138	-	100	70	32	19
TL30-14M-55	30	CF	STEEL	2517	133.69	130.99	138	-	100	70	45	12.5
TL32-14M-55	32	CF	STEEL	2517	142.60	139.88	154	-	108	70	45	12.5
TL34-14M-55	34	CF	STEEL	2517	151.52	148.79	160	-	110	70	45	12.5
TL36-14M-55	36	CF	STEEL	2517	160.43	157.68	168	-	120	70	45	12.5
TL38-14M-55	38	CF	STEEL	2517	169.34	166.6	184	-	130	70	45	12.5
TL40-14M-55	40	CF	STEEL	2517	178.25	175.49	188	-	138	70	45	12.5
TL44-14M-55	44	CF	STEEL	3020	196.08	193.28	211	-	155	70	51	9.5
TL48-14M-55	48	CF	STEEL	3020	213.90	211.11	226	-	170	70	51	9.5
TL56-14M-55	56	ICF	STEEL	3020	249.55	246.76	256	170	208	70	51	9.5
TL64-14M-55	64	ICF	CAST IRON	3020	285.21	282.41	296	170	240	70	51	9.5
TL72-14M-55	72	IC	CAST IRON	3020	320.86	318.06	-	170	280	70	51	9.5
TL80-14M-55	80	IA	CAST IRON	3020	356.51	353.71	-	170	315	70	51	9.5
TL90-14M-55	90	IA	CAST IRON	3020	401.07	398.28	-	170	360	70	51	9.5
TL112-14M-55	112	IA	CAST IRON	3020	499.11	496.32	-	170	457	70	51	9.5
TL144-14M-55	144	IA	CAST IRON	3020	641.71	638.92	-	170	600	70	51	9.5
TL168-14M-55	168	IA	CAST IRON	3020	748.66	745.87	-	170	706	70	51	9.5
TL192-14M-55	192	IA	CAST IRON	3020	855.62	852.82	-	170	813	70	51	9.5
TL216-14M-55	216	GA	CAST IRON	3535	962.57	959.76	-	170	920	70	89	5.5

**HTD 14M-85**

CCGMF CODE 规格	Z 齿数	Type 结构	MAT. 材料	BUSH NO. 锥孔号	Od	De	Df	d3	D1	W	L	K
TL28-14M-85	28	CF	STEEL	2517	124.78	122.12	128	-	98	102	45	28.5
TL29-14M-85	29	CF	STEEL	2517	129.23	126.57	138	-	100	102	45	28.5
TL30-14M-85	30	CF	STEEL	2517	133.69	130.99	138	-	100	102	45	28.5
TL32-14M-85	32	CF	STEEL	2517	142.60	139.88	154	-	108	102	45	28.5
TL34-14M-85	34	CF	STEEL	2517	151.52	148.79	160	-	110	102	45	28.5
TL36-14M-85	36	CF	STEEL	3020	160.43	157.68	168	-	120	102	51	25.5
TL38-14M-85	38	CF	STEEL	3020	169.34	166.6	184	-	130	102	51	25.5
TL40-14M-85	40	CF	STEEL	3020	178.25	175.49	188	-	138	102	51	25.5
TL44-14M-85	44	CF	STEEL	3020	196.08	193.28	211	-	153	102	51	25.5
TL48-14M-85	48	CF	STEEL	3020	213.90	211.11	226	-	170	102	51	25.5
TL56-14M-85	56	CF	STEEL	3525	249.55	246.76	256	190	210	102	51	25.5
TL64-14M-85	64	ICF	CAST IRON	3525	285.21	282.41	296	190	240	102	65	18.5
TL72-14M-85	72	IC	CAST IRON	3525	320.86	318.06	-	190	280	102	65	18.5
TL80-14M-85	80	IA	CAST IRON	3525	356.51	353.71	-	190	315	102	65	18.5
TL90-14M-85	90	IA	CAST IRON	3525	401.07	398.28	-	190	360	102	65	18.5
TL112-14M-85	112	IA	CAST IRON	3525	499.11	496.32	-	190	457	102	65	18.5
TL144-14M-85	144	IA	CAST IRON	3525	641.71	638.92	-	190	600	102	65	18.5
TL168-14M-85	168	IA	CAST IRON	3525	748.66	745.87	-	190	706	102	65	18.5
TL192-14M-85	192	CA	CAST IRON	4040	855.62	852.82	-	190	813	102	102	-
TL216-14M-85	216	CA	CAST IRON	4040	962.57	959.76	-	190	920	102	102	-



**HTD 14M-115**

CCGMF CODE 规格	Z 齿数	Type 结构	MAT. 材料	BUSH NO. 锥孔号	Od	De	Df	d3	D1	W	L	K
TL28-14M-115	28	CF	STEEL	2517	124.78	122.12	128	-	98	133	45	44
TL29-14M-115	29	CF	STEEL	2517	129.23	126.57	138	-	100	133	45	44
TL30-14M-115	30	CF	STEEL	2517	133.69	130.99	138	-	100	133	45	44
TL32-14M-115	32	CF	STEEL	2517	142.60	139.88	154	-	108	133	45	44
TL34-14M-115	34	CF	STEEL	2517	151.52	148.79	160	-	110	133	45	44
TL36-14M-115	36	CF	STEEL	3020	160.43	157.68	168	-	125	133	51	41
TL38-14M-115	38	CF	STEEL	3020	169.34	166.6	184	-	130	133	51	41
TL40-14M-115	40	CF	STEEL	3020	178.25	175.49	188	-	138	133	51	41
TL44-14M-115	44	CF	STEEL	3020	196.08	193.28	211	-	155	133	76	28.5
TL48-14M-115	48	CF	STEEL	3020	213.90	211.11	226	-	170	133	76	28.5
TL56-14M-115	56	CF	STEEL	3535	249.55	246.76	256	-	208	133	89	22
TL64-14M-115	64	ICF	CAST IRON	3535	285.21	282.41	296	190	240	133	89	22
TL72-14M-115	72	IC	CAST IRON	3535	320.86	318.06	-	190	280	133	89	22
TL80-14M-115	80	IA	CAST IRON	3535	356.51	353.71	-	190	315	133	89	22
TL90-14M-115	90	IA	CAST IRON	3535	401.07	398.28	-	190	360	133	89	22
TL112-14M-115	112	IA	CAST IRON	3535	499.11	496.32	-	190	457	133	89	22
TL144-14M-115	144	IA	CAST IRON	4040	641.71	638.92	-	230	600	133	102	15.5
TL168-14M-115	168	IA	CAST IRON	4040	748.66	745.87	-	230	706	133	102	15.5
TL192-14M-115	192	IA	CAST IRON	4040	855.62	852.82	-	230	813	133	102	15.5
TL216-14M-115	216	IA	CAST IRON	4040	962.57	959.76	-	230	920	133	102	15.5

**HTD 14M-170**

CCGMF CODE 规格	Z 齿数	Type 结构	MAT. 材料	BUSH NO. 锥孔号	Od	De	Df	d3	D1	W	L	K
TL38-14M-170	38	CF	STEEL	3030	169.34	166.60	184	-	130	187	76	55.5
TL40-14M-170	40	CF	STEEL	3030	178.25	175.49	188	-	138	187	76	55.5
TL44-14M-170	44	CF	STEEL	3535	196.08	193.28	211	-	153	187	89	49
TL48-14M-170	48	CF	STEEL	3535	213.90	211.11	226	-	170	187	89	49
TL56-14M-170	56	CF	STEEL	3535	249.55	246.76	256	-	208	187	89	49
TL64-14M-170	64	CF	CAST IRON	4040	285.21	282.41	296	-	240	187	102	42.5
TL72-14M-170	72	IC	CAST IRON	4040	320.86	318.06	-	230	280	187	102	42.5
TL80-14M-170	80	IC	CAST IRON	4040	356.51	353.71	-	230	315	187	102	42.5
TL90-14M-170	90	IA	CAST IRON	4040	401.07	398.28	-	230	360	187	102	42.5
TL112-14M-170	112	IA	CAST IRON	5050	499.11	496.32	-	265	457	187	127	30
TL144-14M-170	144	IA	CAST IRON	5050	641.71	638.92	-	265	600	187	127	30
TL168-14M-170	168	IA	CAST IRON	5050	748.66	745.87	-	265	706	187	127	30
TL192-14M-170	192	IA	CAST IRON	5050	855.62	852.82	-	265	813	187	127	30
TL216-14M-170	216	IA	CAST IRON	5050	962.57	959.76	-	265	920	187	127	30