

**ASA Sprockets for Roller Chains DIN8187-ISO/R 606 - AISI B 29,1**  
**3/8" x 3/16"**

**美标链轮**

**ASA 35B - 1 - 2 - 3 9,525 x 4,77mm**

CHAIN 配套链条尺寸: Pitch 节距: 9,525mm  
Internal width 内链板宽度: 4,77mm  
Roller dia. 滚径: 5,08mm

Sprocket 链轮尺寸: Tooth radius 齿半径 r: 10mm  
Radius width 圆弧倒角宽度 C: 1,2mm  
Tooth width 齿宽 h1: 4,4mm  
Tooth width 齿宽 L: 4,3mm  
Tooth width 齿宽 h2: 14,4mm  
Tooth width 齿宽 h3: 24,5mm  
Full high 总高 H: -

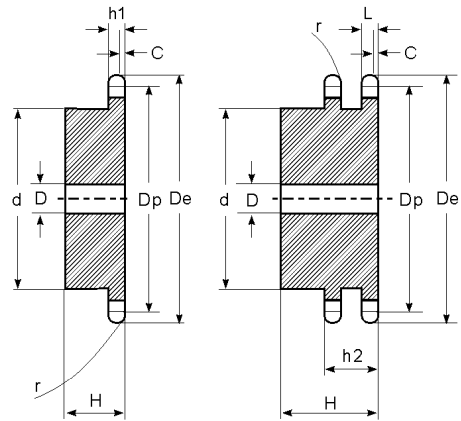

Teeth 齿数	De 外 径	Dp 节 径	Simplex 单排			Duplex 双排		
			d 搭径	D 内孔	H 总高	d 搭径	D 内孔	H 总高
10	35.70	30.82	20	8	22			
11	38.69	33.80	22	8	25			
12	41.68	36.80	25	8	25			
13	44.68	39.80	28	10	25	28	10	25
14	47.68	42.80	31	10	25	31	10	25
15	50.69	45.81	34	10	25	34	10	25
16	53.70	48.82	38	10	28	37	12	30
17	56.72	51.83	38	10	28	40	12	30
18	59.73	54.85	38	10	28	43	12	30
19	62.75	57.87	46	10	28	46	12	30
20	65.77	60.89	46	10	28	49	12	30
21	68.79	63.91	46	10	28	52	16	30
22	71.81	66.93	52	12	28	55	16	30
23	74.83	69.95	52	12	28	58	16	30
24	77.85	72.97	52	12	28	61	16	30
25	80.88	76.00	58	12	28	64	16	30
26	83.90	79.02	58	12	28	67	16	30
27	86.93	82.04	58	12	28	70	16	30
28	89.95	85.07	60	12	28	73	16	30
30	96.00	91.12	60	12	28			

**ASA Sprockets for Roller Chains DIN8187-ISO/R 606 - AISI B 29,1**  
**1/2" x 5/16"**

美标链轮

**ASA 40B - 1 - 2 - 3 12,7 x 7,94mm**

CHAIN 配套链条尺寸: Pitch 节距: 12,7mm  
Internal width 内链板宽度: 7,94mm  
Roller dia. 滚径: 7,94mm

Sprocket 链轮尺寸: Tooth radius 齿半径 r: 13,5mm  
Radius width 圆弧倒角宽度 C: 1,6mm  
Tooth width 齿宽 h1: 7,4mm  
Tooth width 齿宽 L: 7,2mm  
Tooth width 齿宽 h2: 21,6mm  
Tooth width 齿宽 h3: 36mm  
Full high 总高 H: -

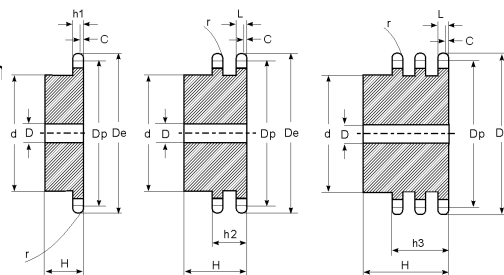

Teeth 齿数	De 外径	Dp 节径	Simplex 单排			Duplex 双排			Triplex 三排		
			d 搭径	D内孔	H 总高	d 搭径	D内孔	H 总高	d 搭径	D内孔	H 总高
10	47.66	41.10	26	10	25						
11	51.64	45.08	29	10	25						
12	55.63	49.07	35	10	28				35	14	50
13	59.63	53.07	35	10	28	38	12	35	38	14	50
14	63.63	57.07	35	10	28	42	12	35	42	14	50
15	67.64	61.08	48	10	28	46	12	35	46	14	50
16	71.66	65.10	48	10	28	50	14	35	50	16	50
17	75.68	69.12	48	10	28	54	14	35	54	16	50
18	79.70	73.14	60	12	28	58	14	35	58	16	50
19	83.72	77.16	60	12	28	62	14	35	62	16	50
20	87.74	81.18	60	12	28	66	14	35	66	16	50
21	91.77	85.21	65	12	28	70	16	40	70	20	55
22	95.80	89.24	65	12	28	70	16	40	70	20	55
23	99.83	93.27	65	12	28	70	16	40	70	20	55
24	103.86	97.30	70	14	28	75	16	40	75	20	55
25	107.89	101.33	70	14	28	80	16	40	80	20	55
26	111.92	105.36	70	14	28	85	20	40	85	20	55
27	115.96	109.40	70	16	30	85	20	40	85	20	55
28	119.99	113.43	70	16	30	90	20	40	90	20	55
30	128.06	121.50	80	16	30	100	20	40			
32	136.13	129.57	80	16	30						
35	148.24	141.68	90	16	30						
36	152.28	145.72	90	16	30						
38	160.35	153.79	90	16	35						
40	168.43	161.87	90	16	35						



**ASA Sprockets for Roller Chains DIN8187-ISO/R 606 - AISI B 29,1 美标链轮**  
**5/8" x 3/8" ASA 50B - 1 - 2 - 3 15,875 x 9,52mm**

CHAIN 配套链条尺寸: Pitch 节距: 15,875mm  
Internal width 内链板宽度: 9,52mm  
Roller dia. 滚径: 10,16mm

Sprocket 链轮尺寸: Tooth radius 齿半径 r: 17mm  
Radius width 圆弧倒角宽度 C: 2mm  
Tooth width 齿宽 h1: 9mm  
Tooth width 齿宽 L: 8,8mm  
Tooth width 齿宽 h2: 26,9mm  
Tooth width 齿宽 h3: 45mm  
Full high 总高 H: -

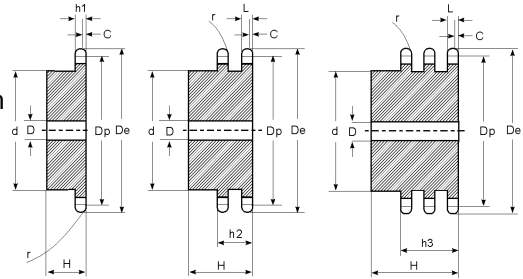

Teeth 齿数	De 外径	Dp 节径	Simplex 单排			Duplex 双排			Triplex 三排		
			d 搭径	D内孔	H 总高	d 搭径	D内孔	H 总高	d 搭径	D内孔	H 总高
8	47,0	41,48	25	10	25						
9	52,6	46,42	30	10	25						
10	57,5	51,37	35	10	25						
11	63,0	56,34	37	12	30						
12	68,0	61,34	42	12	30				44	16	55
13	73,0	66,32	47	12	30	49	14	40	49	16	55
14	78,0	71,34	52	12	30	54	14	40	54	16	55
15	83,0	76,36	57	12	30	59	14	40	59	16	55
16	88,0	81,37	60	12	30	64	16	45	64	16	60
17	93,0	86,39	60	12	30	69	16	45	69	16	60
18	98,3	91,42	70	14	30	74	16	45	74	16	60
19	103,3	96,45	70	14	30	79	16	45	79	16	60
20	108,4	101,49	75	14	30	84	16	45	84	16	60
21	113,4	106,52	75	16	30	85	16	45	85	20	60
22	118,0	111,55	80	16	30	90	16	45	90	20	60
23	123,4	116,58	80	16	30	95	16	45	95	20	60
24	128,3	121,62	80	16	30	100	16	45	100	20	60
25	134,4	126,66	80	16	30	105	16	45	105	20	60
26	139,0	131,70	85	20	35				110	20	60
27	144,0	136,75	85	20	35				110	20	60
28	148,7	141,78	90	20	35				115	20	60
29	153,8	146,83	90	20	35						
30	158,8	151,87	90	20	35						
31	163,9	156,92	95	20	35						
32	168,9	161,95	95	20	35						
33	174,5	167,00	95	20	35						
34	179,0	172,05	95	20	35						
35	184,1	177,10	95	20	35						
36	189,1	182,15	100	20	35						
37	194,2	187,20	100	20	35						
38	199,2	192,24	100	20	35						
39	204,2	197,29	100	20	35						
40	209,3	202,34	100	20	35						



**ASA Sprockets for Roller Chains DIN8187-ISO/R 606 - AISI B 29,1 美标链轮**  
**3/4" x 1/2" ASA 60B - 1 - 2 - 3 19,05 x 12,7mm**

CHAIN 配套链条尺寸: Pitch 节距: 19,05mm  
Internal width 内链板宽度: 12,7mm  
Roller dia. 滚径: 11,91mm

Sprocket 链轮尺寸: Tooth radius 齿半径 r: 20mm  
Radius width 圆弧倒角宽度 C: 2,4mm  
Tooth width 齿宽 h1: 12mm  
Tooth width 齿宽 L: 11,8mm  
Tooth width 齿宽 h2: 34,6mm  
Tooth width 齿宽 h3: 57,4mm  
Full high 总高 H: -

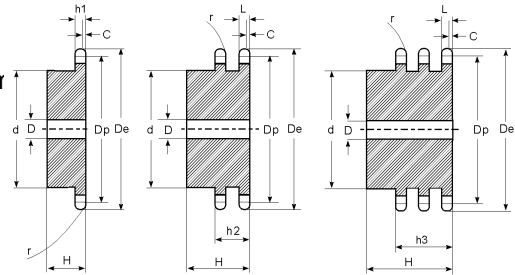

Teeth 齿数	De 外径	Dp 节径	Simplex 单排			Duplex 双排			Triplex 三排		
			d 搭径	D内孔	H 总高	d 搭径	D内孔	H 总高	d 搭径	D内孔	H 总高
10	71,54	61,64	42	12	30	42	12	45			
11	77,51	67,61	45	12	30	47	16	50			
12	83,49	73,61	45	12	30	53	16	50	53	20	70
13	89,49	79,59	60	14	35	59	16	50	59	20	70
14	95,50	85,61	60	14	35	65	16	50	65	20	70
15	101,52	91,63	60	14	35	71	16	50	71	20	70
16	107,54	97,65	75	16	35	77	20	50	77	20	70
17	113,56	103,67	75	16	35	83	20	50	83	20	70
18	119,59	109,71	75	16	35	89	20	50	89	20	70
19	125,63	115,75	80	16	35	95	20	50	95	20	70
20	131,67	121,78	80	16	35	100	20	50	100	20	70
21	137,71	127,82	80	16	35	100	20	50	100	20	70
22	143,75	133,86	90	20	40	100	20	50	100	20	70
23	149,79	139,90	90	20	40	110	20	50	110	20	70
24	155,84	145,94	90	20	40	110	20	50	110	20	70
25	161,88	152,00	90	20	40	120	20	50	120	20	70
26	167,93	158,04	90	20	40	120	20	50			
27	173,98	164,09	90	20	40	120	20	50			
28	180,03	170,13	90	20	40	120	20	50			
30	192,14	182,25	95	20	40	120	20	50			

**ASA Sprockets for Roller Chains DIN8187-ISO/R 606 - AISI B 29,1 美标链轮**  
**1" x 5/8" ASA 80B - 1 - 2 - 3 25,4 x 15,88mm**

CHAIN 配套链条尺寸: Pitch 节距: 25,4mm  
Internal width 内链板宽度: 15,88mm  
Roller dia. 滚径: 15,88mm

Sprocket 链轮尺寸: Tooth radius 齿半径 r: 27mm  
Radius width 圆弧倒角宽度 C: 3,2mm  
Tooth width 齿宽 h1: 15mm  
Tooth width 齿宽 L: 14,7mm  
Tooth width 齿宽 h2: 44mm  
Tooth width 齿宽 h3: 73,3mm  
Full high 总高 H: -

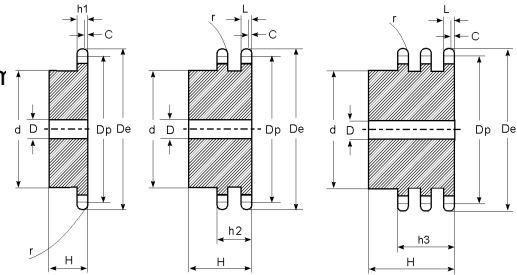

Teeth 齿数	De 外径	Dp 节径	Simplex 单排			Duplex 双排			Triplex 三排		
			d 搭径	D内孔	H 总高	d 搭径	D内孔	H 总高	d 搭径	D内孔	H 总高
8	79,48	66,37	42	16	35						
9	87,38	74,27	50	16	35						
10	95,32	82,19	55	16	35						
11	103,28	90,14	61	16	40						
12	111,26	98,14	69	16	40	72	20	70	72	25	100
13	119,26	106,12	78	16	40	80	20	70	80	25	100
14	127,27	114,15	84	16	40	88	20	70	88	25	100
15	135,29	122,17	92	16	40	96	20	70	96	25	100
16	143,32	130,20	100	20	45	104	20	70	104	30	100
17	151,35	138,22	100	20	45	112	20	70	112	30	100
18	159,39	146,28	100	20	45	120	20	70	120	30	100
19	167,44	154,33	100	20	45	128	20	70	128	30	100
20	175,49	162,38	100	20	45	130	20	70	130	30	100
21	183,54	170,43	110	20	50	130	25	70			
22	191,60	178,48	110	20	50						
23	199,66	186,53	110	20	50						
24	207,72	194,59	110	20	50						
25	215,78	202,66	110	20	50						
26	223,84	210,72	120	20	50						
27	231,91	218,79	120	20	50						
28	239,98	226,85	120	20	50						
29	248,05	234,92	120	20	50						
30	256,12	243,00	120	20	50						

**ASA Sprockets for Roller Chains DIN8187-ISO/R 606 - AISI B 29,1 美标链轮**  
**1" 1/4 x 3/4" ASA 100B -1 -2 -3 31,75 x 19,05mm**

CHAIN 配套链条尺寸: Pitch 节距: 31,75mm  
Internal width 内链板宽度: 19,05mm  
Roller dia. 滚径: 19,05mm

Sprocket 链轮尺寸: Tooth radius 齿半径 r: 33,5mm  
Radius width 圆弧倒角宽度 C: 4mm  
Tooth width 齿宽 h1: 18mm  
Tooth width 齿宽 L: 17,7mm  
Tooth width 齿宽 h2: 53,5mm  
Tooth width 齿宽 h3: 89,2mm  
Full high 总高 H: -

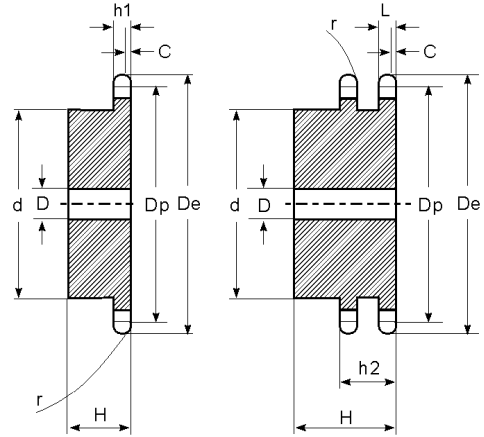

Teeth 齿数	De 外径	Dp 节径	Simplex 单排			Duplex 双排		
			d 搭径	D 内孔	H 总高	d 搭径	D 内孔	H 总高
8	98,1	82,96	53	20	40			
9	108,0	92,84	63	20	40			
10	117,9	102,74	70	20	40			
11	127,8	112,68	77	20	45			
12	137,8	122,68	88	20	45	90	20	80
13	147,8	132,65	98	20	45	100	20	80
14	157,8	142,68	108	20	45	110	20	80
15	167,9	152,72	118	20	45	120	20	80
16	177,9	162,75	120	25	50	120	25	80
17	187,9	172,78	120	25	50	120	25	80
18	198,0	182,85	120	25	50			
19	208,1	192,91	120	25	50			
20	218,1	202,98	120	25	50			
21	228,2	213,04	140	25	55			
22	238,3	223,11	140	25	55			
23	248,3	233,17	140	25	55			
24	258,4	243,23	140	25	55			
25	268,5	253,33	140	25	55			

**ASA Sprockets for Roller Chains DIN8187-ISO/R 606 - AISI B 29,1 美标链轮**  
**1" 1/2 x 1" ASA 120B - 1 - 2 - 3 38,1 x 25,4mm**

CHAIN 配套链条尺寸: Pitch 节距: 38,1mm  
Internal width 内链板宽度: 25,4mm  
Roller dia. 滚径: 22,22mm

Sprocket 链轮尺寸: Tooth radius 齿半径 r: 40,5mm  
Radius width 圆弧倒角宽度 C: 4,8mm  
Tooth width 齿宽 h1: 24,1mm  
Tooth width 齿宽 L: 23,6mm  
Tooth width 齿宽 h2: 69mm  
Tooth width 齿宽 h3: 114,5mm  
Full high 总高 H: -

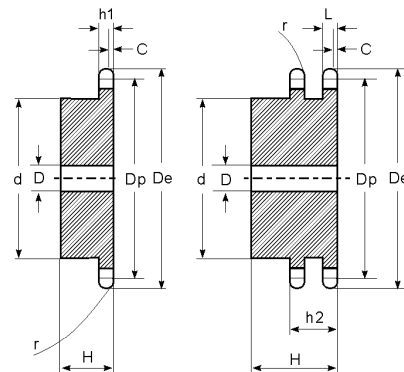

Teeth 齿数	De 径 外	Dp 节径	Simplex 单排			Duplex 双排		
			d 搭径	D 内孔	H 总高	d 搭径	D 内孔	H 总高
8	119,04	99,55	58	20	45			
9	130,88	111,40	70	20	45			
10	142,77	123,29	80	20	45			
11	154,71	135,21	90	25	50			
12	166,69	147,22	102	25	50	102	25	100
13	178,68	159,18	114	25	50	114	25	100
14	190,70	171,22	128	25	50	128	25	100
15	202,73	183,26	140	25	50	140	25	100

**1"3/4 x 1"1/4 ASA 140B - 1 - 2 - 3 44,45 x 25,4mm**

CHAIN 配套链条尺寸: Pitch 节距: 44,45mm  
Internal width 内链板宽度: 25,4mm  
Roller dia. 滚径: 25,4mm

Sprocket 链轮尺寸: Tooth radius 齿半径 r: 47,5mm  
Radius width 圆弧倒角宽度 C: 5,8mm  
Tooth width 齿宽 h1: 24,1mm  
Tooth width 齿宽 L: 23,6mm  
Tooth width 齿宽 h2: 72,5mm  
Tooth width 齿宽 h3: 121,3mm  
Full high 总高 H: -

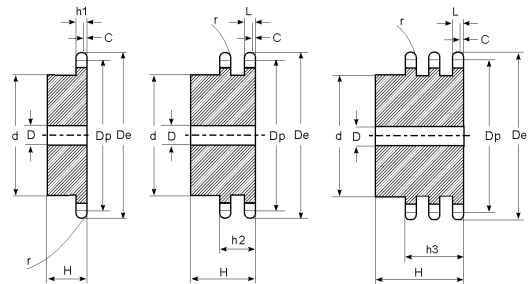

**2" x 1"1/4 ASA 160B - 1 - 2 - 3 50,8 x 31,75mm**

CHAIN 配套链条尺寸: Pitch 节距: 50,8mm  
Internal width 内链板宽度: 31,75mm  
Roller dia. 滚径: 28,58mm

Sprocket 链轮尺寸: Tooth radius 齿半径 r: 54mm  
Radius width 圆弧倒角宽度 C: 7mm  
Tooth width 齿宽 h1: 30,1mm  
Tooth width 齿宽 L: 29,5mm  
Tooth width 齿宽 h2: 88mm  
Tooth width 齿宽 h3: 146,6mm  
Full high 总高 H: -

